

UR-W120/15

UNION RAIL WA WELDED BASE FIXING



Ph: 1800 099 788 | info@unionrail.com.au | www.unionrail.com.au

The Union Rail WA UR-W120/15 adjustable crane rail clip is designed to fix heavy rails in the most arduous applications.

It can withstand a horizontal force from the rail of 125kN

Its low profile allows it to be used with cranes that are fitted with guide rollers.

DIMENSIONS (mm):

REF NO.	A	B (FULL NUT)	C	WEIGHT kg
UR-W120-15-38	38	48	30	0.90
UR-W120-15-41	41	48	30	0.95

SPECIFICATIONS:

Max Side Load using Grade 8.8 Bolt: 125kN

Horizontal Rail Adjustment: 15 mm

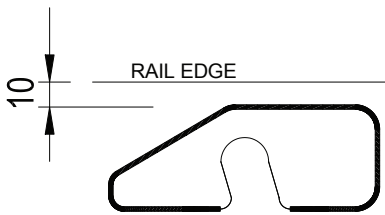

RAIL WITH PAD

RAIL WITHOUT PAD

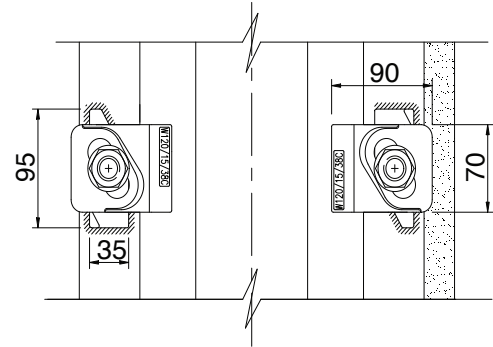
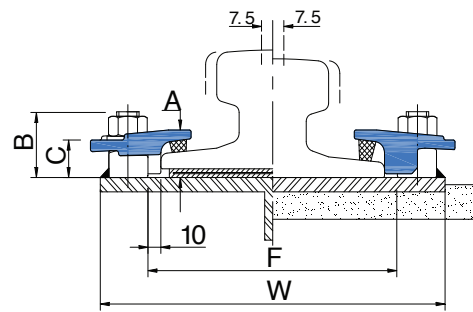

Minimum assembly width (W) = Rail Width (F) + 105mm

Weld along back and sides of clip base with a 4mm throat thickness fillet weld. Use low hydrogen electrodes.

TIGHTENING TORQUE:

Grade 8.8 bolt 350Nm

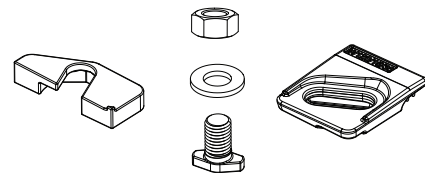

UR-W120/15

	F mm	T mm	H mm	RAIL WITH PAD	RAIL WITHOUT PAD
A 75	200	75	85	UR-W120-15-38	UR-W120-15-38
A 100	200	100	95	UR-W120-15-38	UR-W120-15-38
A 120	220	120	105	UR-W120-15-38	UR-W120-15-38
A 150	220	150	150	UR-W120-15-38	UR-W120-15-38
QU 70	120	70	120	UR-W120-15-38	UR-W120-15-38
QU 80	130	80	130	UR-W120-15-38	UR-W120-15-38
QU 100	150	100	150	UR-W120-15-38	UR-W120-15-38
QU 120	170	120	170	UR-W120-15-38	UR-W120-15-38
CR 73	140	100	135	UR-W120-15-38	UR-W120-15-38
CR 100	155	120	150	UR-W120-15-41	UR-W120-15-38

This clip can be used for a wider selection of rails than illustrated. Please contact URWA for the full range of possible rails. URWA may change or improve their products and also alter specifications without notice.